



# Madhuram

ENCLAVE



39 PREMIUM ADDRESSES

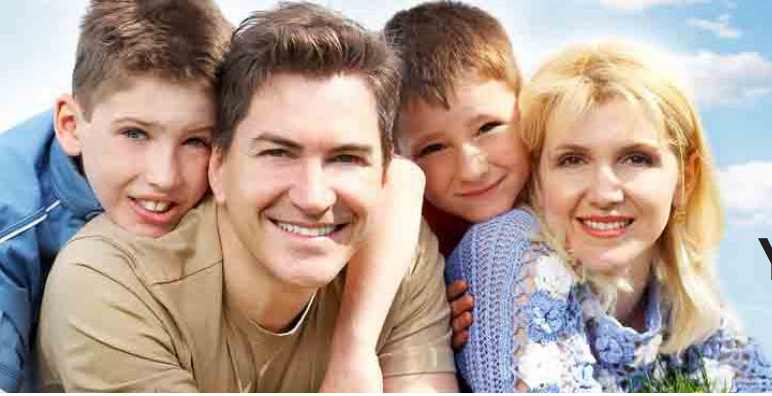

Your **DREAMS...**  
our **PROMISE ...**



## About Madhuram Developers

Madhuram Group's voyage flagged off in 1984. We initially started with construction related turnkey projects in Govt. and Private sectors wherein we demonstrated our execution capabilities by delivering high quality work within exceptionally stringent time frames.

It was then way back in 1996 then the Madhuram Group took a giant leap forward... and this marked our entry into the Real estate business.

Since then it has been a fascinating journey through which we have today emerged as one of the prominent establishments in construction business. Our ascent to the peak is a result of many vital factors, some of which are as follows:

- Providing nothing but the best
- Timely Completion
- Strategic Locations
- Solid Customer Relations

### ONGOING PROJECTS



**Mangal Bhoomi, Airport - Udaipur**



**Dharti 1 Enclave, Dabok, Udaipur**

# A *Jewel* in the heart of city Madhuram Enclave



## Salient Features:

- ✓ Centrally Located in the heart of the city.
- ✓ Famous Benchmarks like Gulab bagh, Lake Picchola, City Palace, Shreenath Ji Mandir etc. in-proximity.
- ✓ Only 1.5kms from Central Bus Stand & Central Railway Station.
- ✓ State of Art Elevation design.
- ✓ Optimized planning based on Vastu concepts.
- ✓ Earthquake resistant R.C.C. Frame Structure.
- ✓ Ample parking space - open as well as covered.
- ✓ Funding available from nationalized banks.



## Specifications:

- ✓ Vitrified tile flooring in flats.
- ✓ Granite Kitchen platform with Stainless steel sink.
- ✓ Ceramics tiled dado upto lintel height in all toilets.
- ✓ Decorative main door with S.S. fittings.
- ✓ Wooden frame flush door with S.S. fittings on all internal doors.
- ✓ Aluminum section windows.
- ✓ Concealed copper wiring with adequate points in all rooms.
- ✓ Concealed plumbing work with ISI fittings.
- ✓ Ground water source connected to overhead tanks.
- ✓ Sandlaw finish on interior walls.

# PLANS

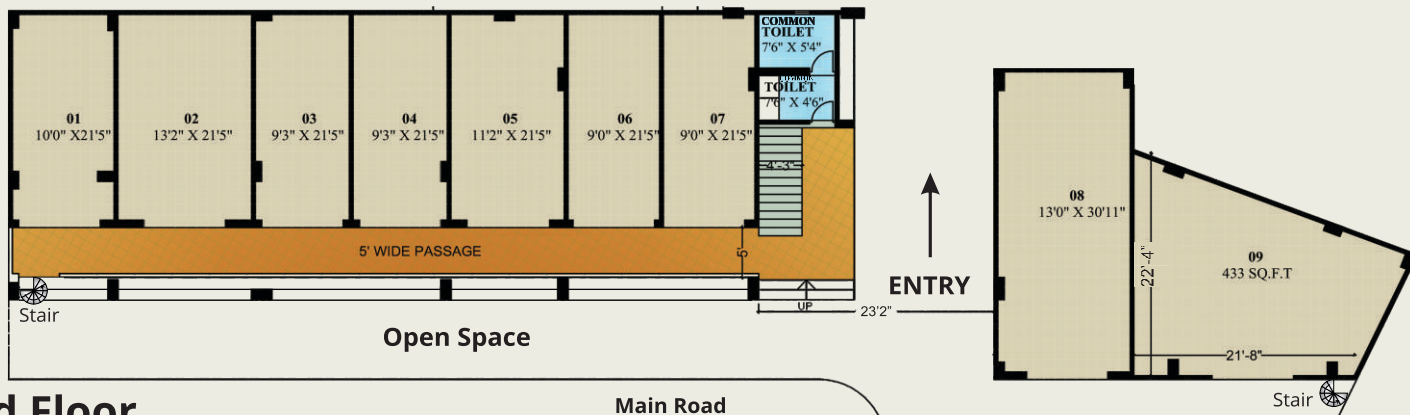

## Ground Floor

S.No.	1	2	3	4	5	6	7	8	9
Area (Sq.ft.)	229.75	293.75	209.25	209.25	250.00	204.00	208.00	423.75	462.50

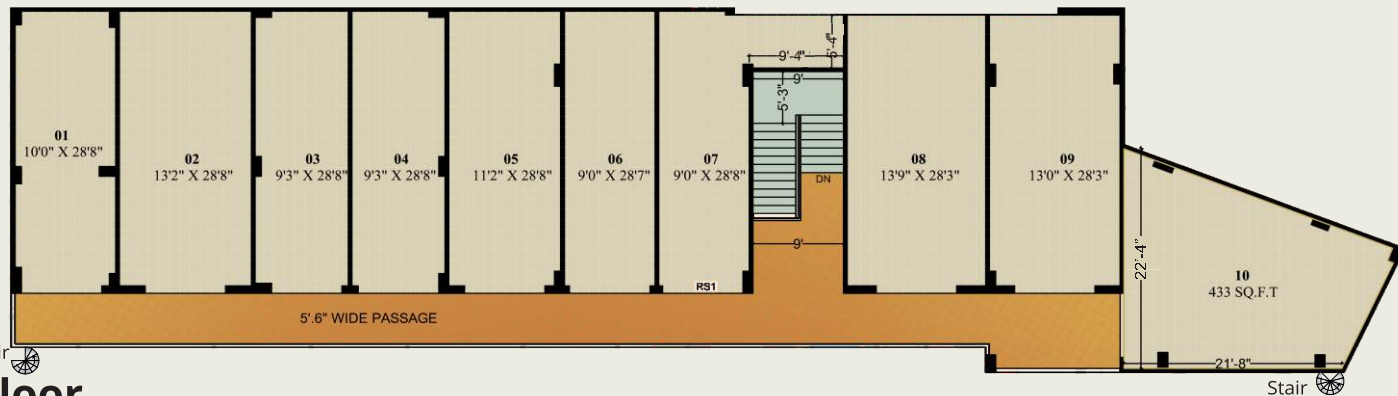

## First Floor

S.No.	1	2	3	4	5	6	7	8	9	10
Area (Sq.ft.)	306.5	391.5	279.25	279.25	333.5	271.75	328.75	404.5	377.75	462.50

# TYPICAL FLOOR PLAN



FLAT NO.	SUPER BUILT UP AREA (Sq.Ft.)
1.	1395.00
2.	1425.00
3.	1395.00
4.	1878.00
5.	1682.00
6.	2110.00



Main Road

# SCHEMATIC 3BHK MODEL



# SCHEMATIC 2BHK MODEL



## SPECIFIC NOTES :

- Developer reserves the rights for alteration of specifications and design.
- All dimensions and area are approximate, average and subject to variations.
- Irregular payments shall incur interest or cancellation of booking.
- All government taxes, Stamp & Registration Charges, Legal Expenses, Society Membership fees, maintenance fees shall be borne by the members.
- This brochure is not to be treated as a part of the legal documents. It is only meant for the easy display of the project.

## LOCATION MAP



Developers

## MADHURAM DEVELOPERS

**Head Office :** 06 - Vinayak Complex, A - Block

Durga Nursery Road, Udaipur (Raj.) **Call :** Milin B. Shah +91 90014 20619

[www.madhuramdevelopers.com](http://www.madhuramdevelopers.com) | **E-mail :** [info@madhuramdevelopers.com](mailto:info@madhuramdevelopers.com)

## Architects

SURENDRA PARMAR Architects, Ahmedabad

## Structure

Shreeji Structurals, Ahmedabad